

Planning Your Dream Kitchen

Step-by-Step Guide

1. Gather inspiration from our inspiration page
2. Measure the space you are installing your new flat pack in, making sure to measure from wall to wall. You should measure the height of the space from the floor to ceiling.

Note: You will need to take note of any windows (especially if using wall or tall cupboards) along with any plumbing or electrical points in the area.

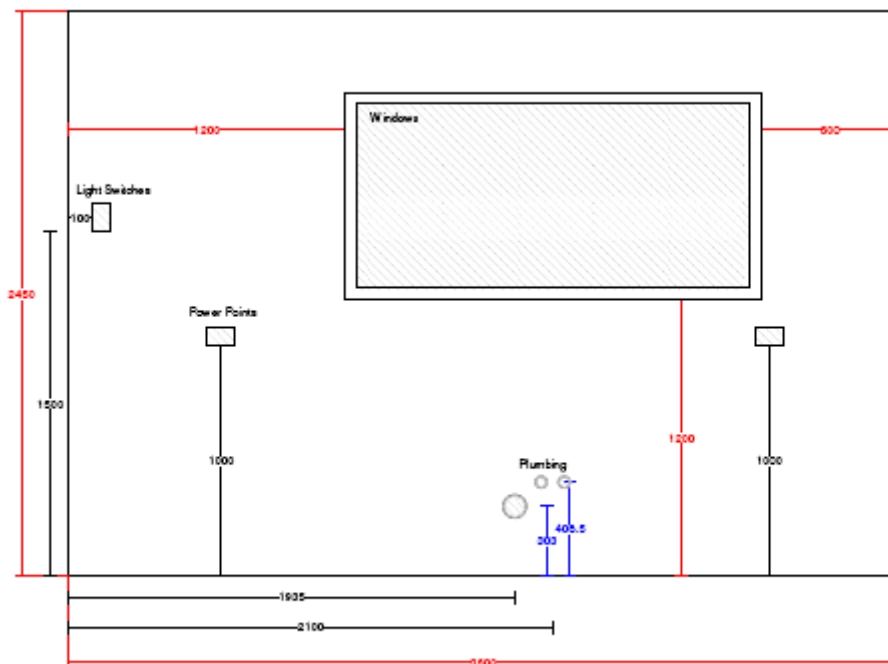

Tips when measuring:

- Note window size and placement, along with trim and sill dimensions. You want to measure your windows and doors from the outside of the trim (moulding or architraves)
- Measure any items that will remain in the room and relate them to your floor plan
- Make note of any plumbing or electrical details, such as light switches and PowerPoints or pipes that will either be remaining or need to be moved.
- Triple check your measurements prior to placing your order. Every competent of your design will reflect your measurements.

3. Choose the kitchen layout which best suits your needs. Check out our basic layouts in the resources tab for ideas.
4. Select the type of kickboards preferred – PLY ladder kicks or legs and kick panels. You will need to allow enough length (linear metres) to cover the base of your bottom kitchen cabinets.

KPLY1412

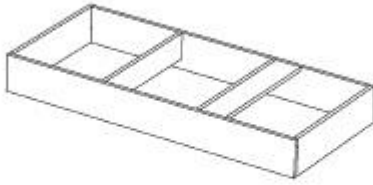

Laminated on Face & Selected End

B1L

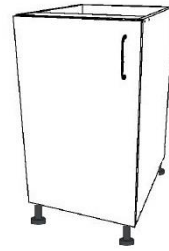

Kick 1412



5. Choose your cupboards – you can use our basic layout tab to help guide your design.
Note: When choosing your cupboards consider which direction you would like your single door cupboards to open.
6. Select your needed end and filler panels.
Hints:
 - End panels are needed anywhere that the side of a cupboard will be seen
 - Filler panels are needed anywhere that your cabinetry is going up against a wall
 - An end panel will be required in between a wall oven tower and other tall cupboards
 - If your cabinetry is going to the ceiling, you will need to make sure you remember your head panels
7. Select your cabinet colours
8. Select your cabinet handles
9. Select your benchtops. You will need to allow enough length (linear metres) to cover the tops of your bottom cupboards. Benchtops come in standard sizes and can be cut down using our cut to size using our cut down service*.
10. Send your quote request – upload any drawings or designs and sales consultants will confirm your layout and requirements. (This quote will include any additional cut down or additional charges that may occur)
11. Receive quote confirmation and accept your quote
12. Make payment in full
13. Receive estimated date for pick up
14. Receive your flat pack – ready to install.

**The cut down service will incur an additional charge*

5000

3600

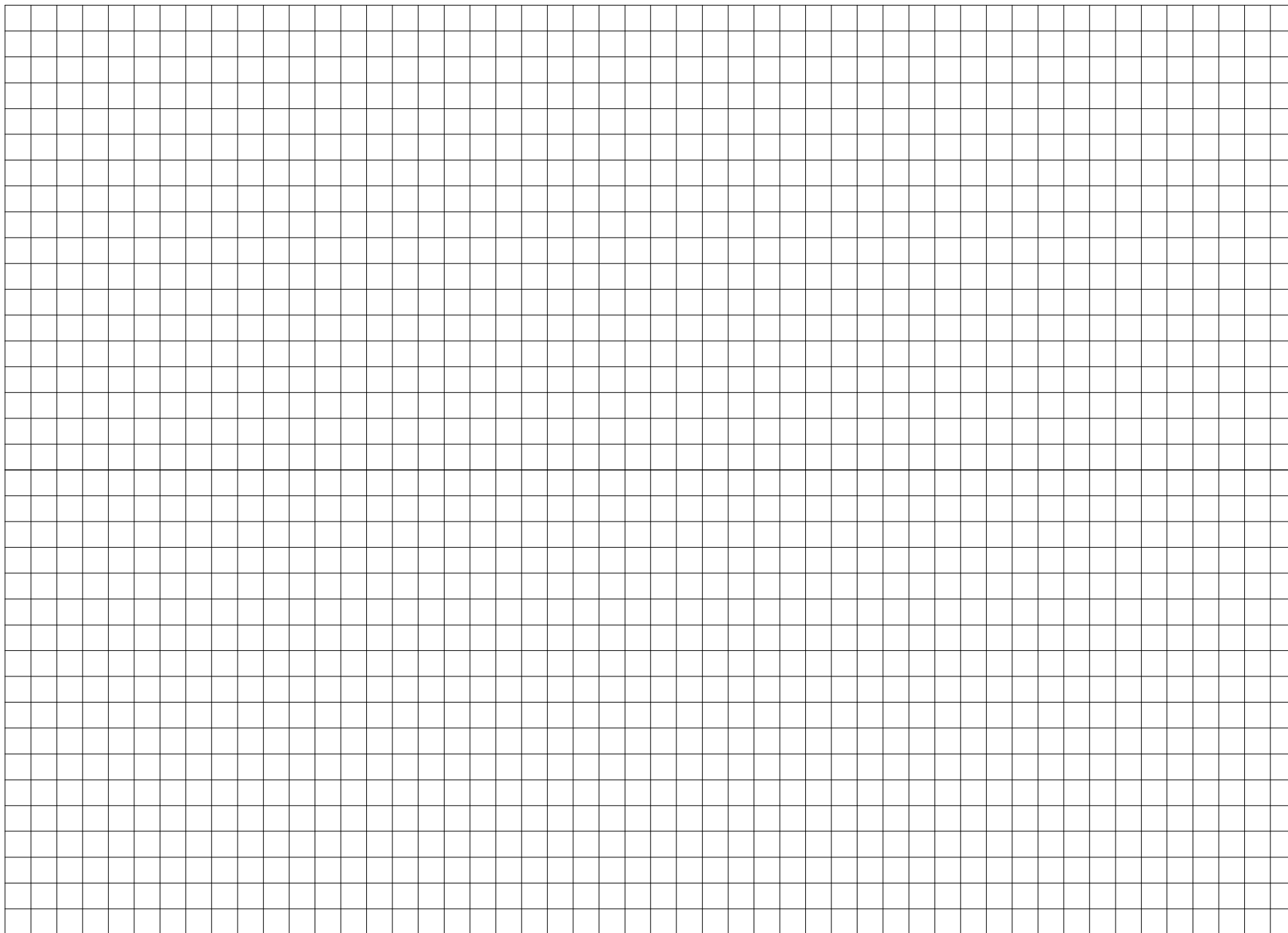

Bottom Cupboards

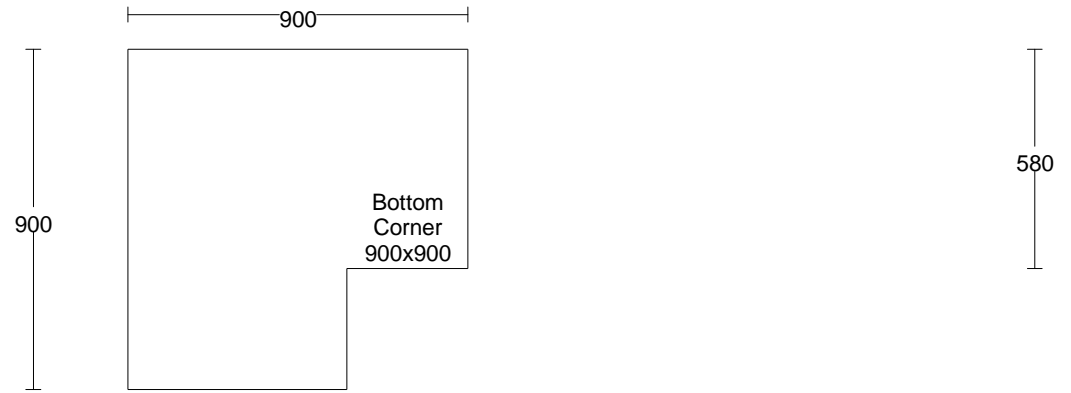
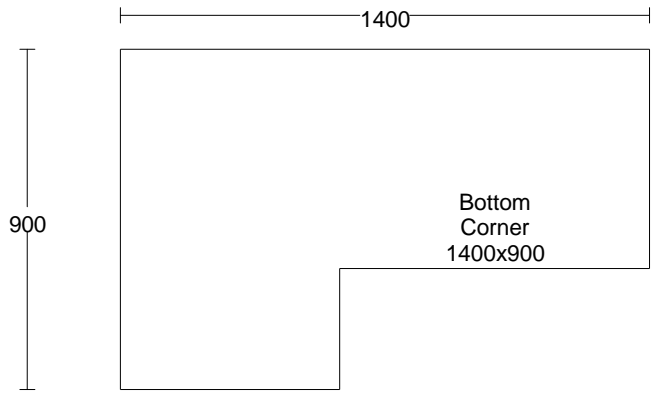
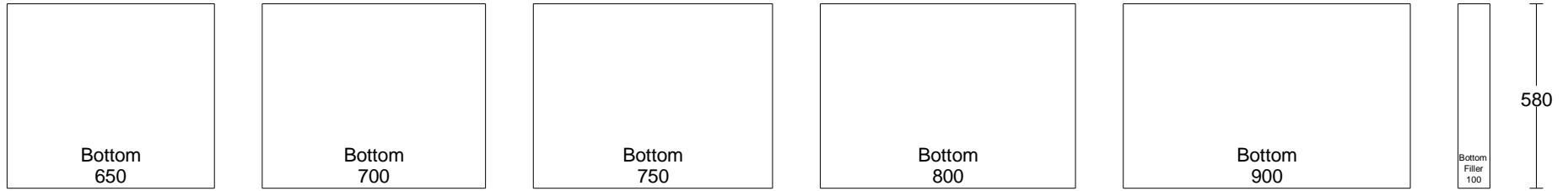
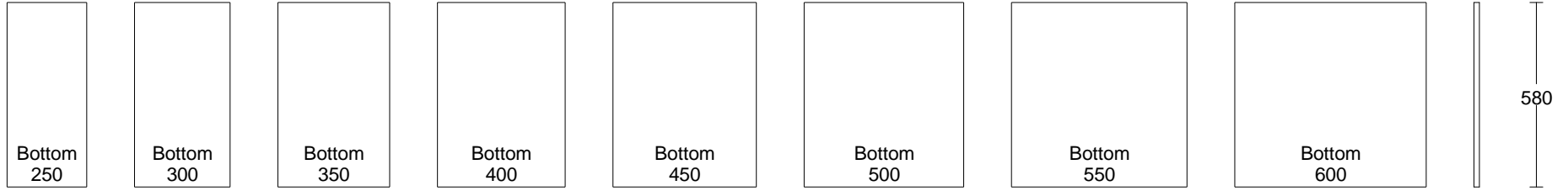

Wall Cupboards

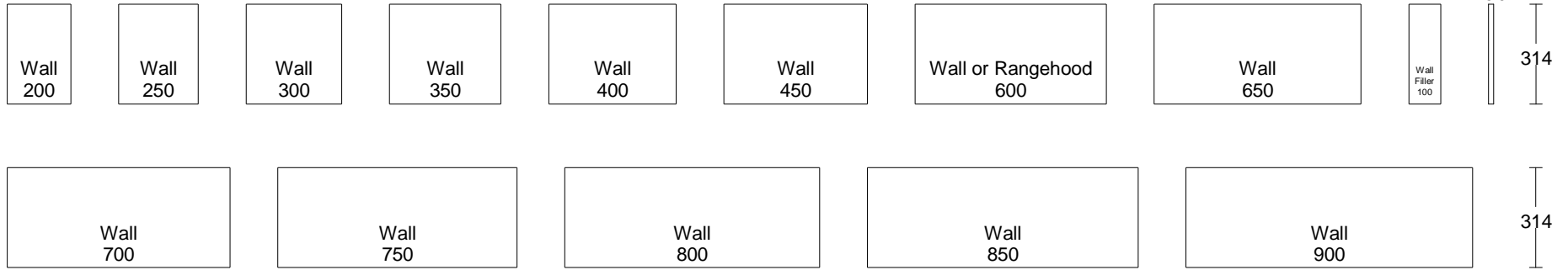

Pantry Cupboards

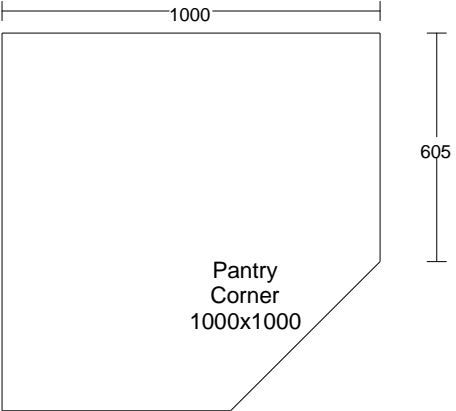
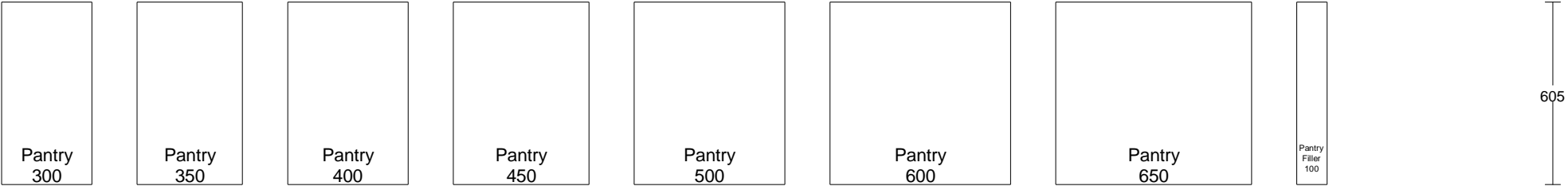

Fridge Cupboards

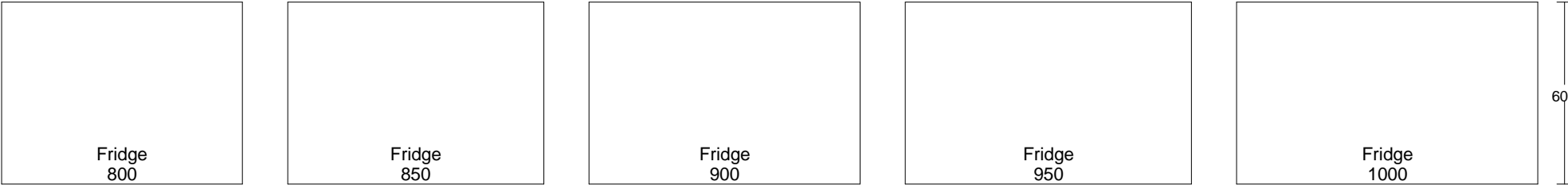

Bathroom Vanity Cupboards

